

ASSEMBLING ACCESSORY 33-053 LEG AND WHEEL KIT

If you purchased the accessory 33-053 leg and wheel kit for your Sawbuck Frame and Trim Saw they should be assembled to the saw as follows.

1. Turn the saw upside down on a supporting surface, such as two sawhorses, and assemble the four outside leg brackets (A) Fig. 1, to the bottom of the saw using the eight 2" long allen screws (B), flatwashers (C), lock washers (D) and hex nuts (E), as shown.

2. Fig. 2, illustrates the four outside leg brackets (A) assembled to the bottom of the saw.

3. Assemble the leg assembly (F) Fig. 3, to the bottom of the leg brackets (A) using the two 1" long hex head screws (G), lockwashers (H), hex nut (J), and clamps (K), and fasten the two leg brackets (Z) to the bottom of the fixed table using the two 1-3/4" long allen screws (L), flatwashers (M), lockwashers (N) and hex nuts (O). Assemble the other end of the leg assembly (F) Fig. 3, to the bottom of the leg bracket and saw in the same manner.

4. Fig. 4, illustrates one leg assembly (F) assembled to the bottom of the saw.

5. Assemble the remaining leg assembly to the opposite end of the saw in the same manner.

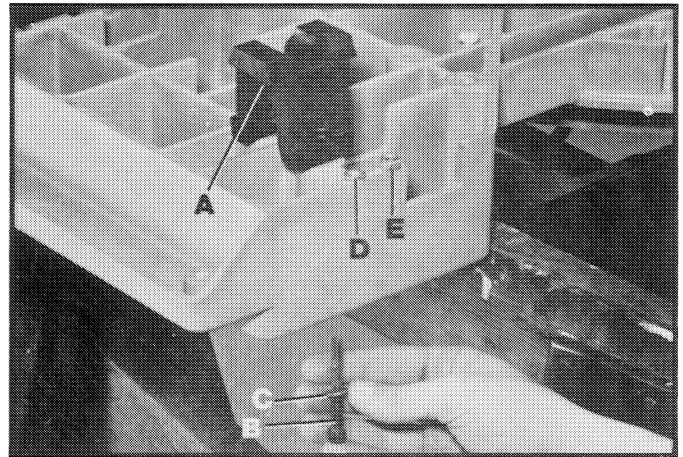

Fig. 1

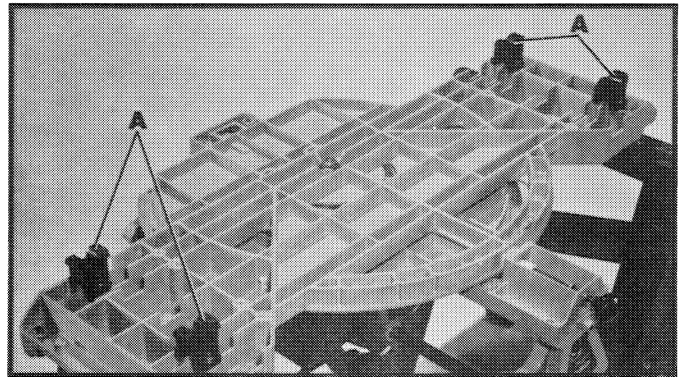

Fig. 2

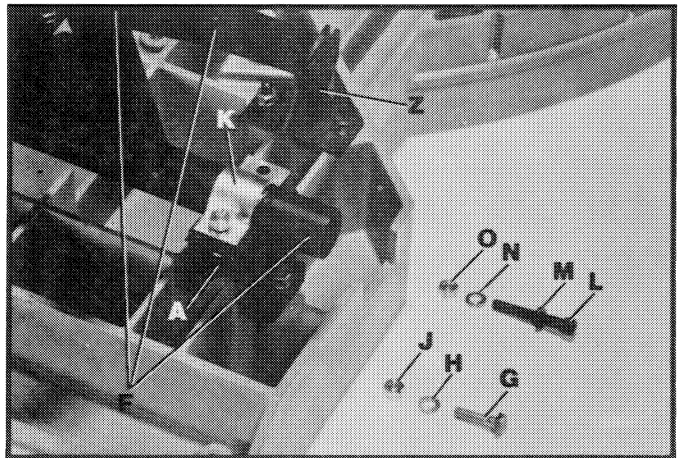

Fig. 3

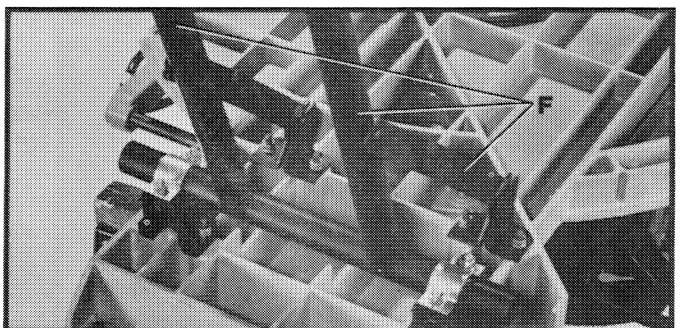

Fig. 4

6. Decide which end of the saw you want the wheels assembled and insert the two nylon bushings, one of which is shown at (R) Fig. 5, to each end of the leg brace (S), as shown.

7. Press push nut (T) onto one end of axle (U), as shown in Fig. 5.

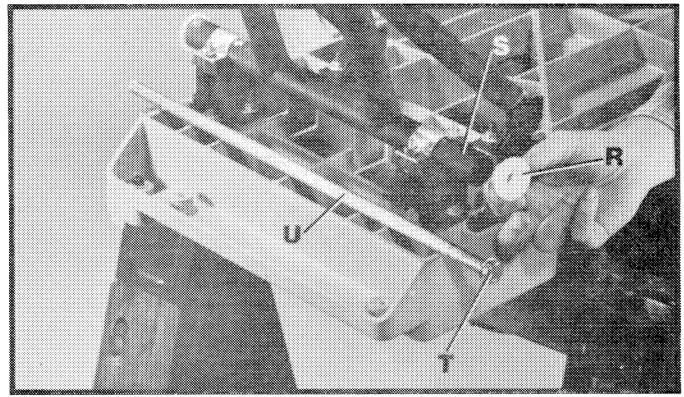

Fig. 5

8. Place wheel (V) Fig. 6, on axle and insert axle through the two nylon bushings in leg brace (S). Assemble wheel (W) and push nut to other end of axle, as shown in Fig. 6.

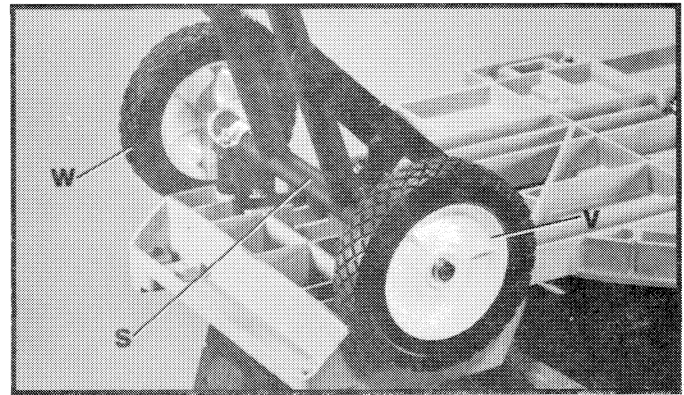

Fig. 6

9. Assemble leg clamp (X) Fig. 7, to two of the holes in the leg assembly opposite the wheels, using the two 5/16" long self-tapping screws (Y) as shown.

10. Place saw in the upright position.

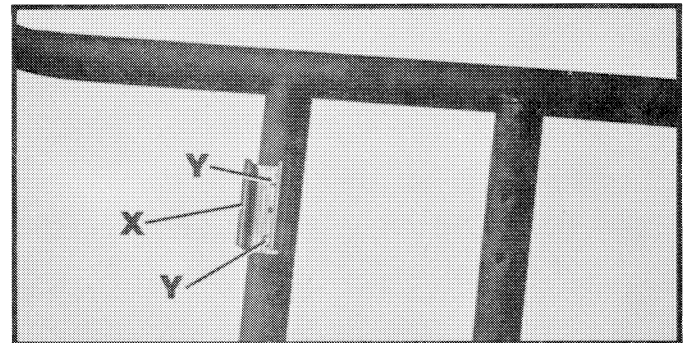
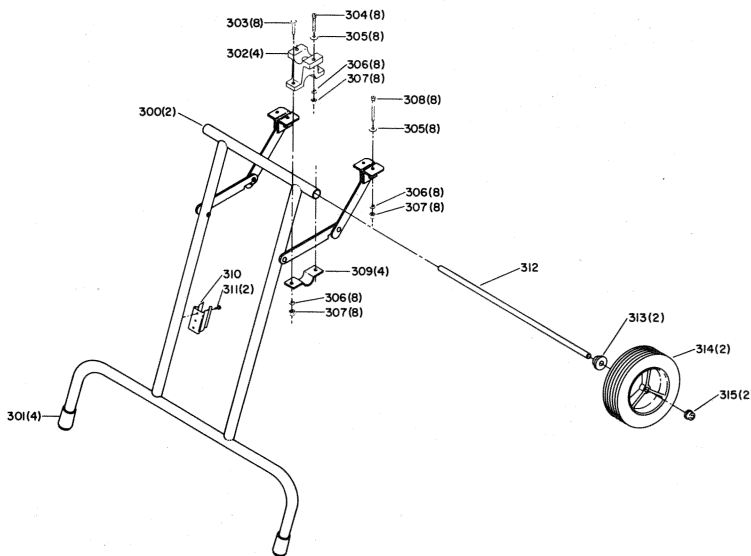

Fig. 7



REPLACEMENT PARTS

REF. NO.	PART NO.	DESCRIPTION
*	33-053	Leg & Wheel Assembly, Const. of:
300	422-32-366-0001	Leg Frame Assembly, Incl:
301	422-25-048-0001	Rubber Foot
302	422-25-014-0004	Bracket
303	901-01-060-0623	1/4-20 x 1" Hex Hd Cap Screw
304	901-03-013-1026	1/4-20 x 1 3/4" Soc Hd Cap Screw
305	904-01-031-5652	1/4" Flat Washer
306	904-02-020-1702	1/4" Lockwasher
307	902-01-120-1034	1/4-20 Hex Nut
308	901-03-010-0230	1/4-20 x 2" Soc Hd Cap Screw
309	422-25-027-0001	Clamp Strap
310	422-25-027-0003	Spring Clip
311	901-06-143-1327	#6-32 x 5/16" Philips Hd Screw
312	422-32-108-0007	Wheel Rod
313	422-25-017-0005	Wheel Bushing
314	422-25-100-0001	Wheel
315	422-25-020-0002	Cap

* NOT SHOWN ASSEMBLED